

CARSON

DR-200 ezRead Electronic Reading Aid

1. Installation of Battery

a) Remove the Battery Door



b) Install 3 AAA size batteries



c) Close the Battery Door

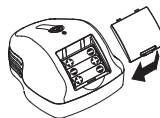

2. Using Power Adapter (Alternative Power Source)

Plug the small end of the Power Cord to the Digital Reader.
Plug the Power Adapter into a 110V Power Outlet

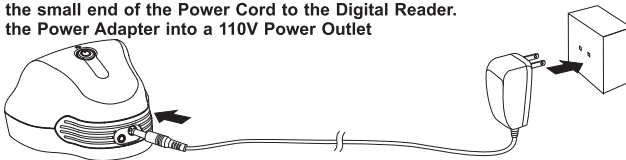

3. Connecting the Digital Reader to Television Set

Television needs to be on the Video setting for the Digital Reader to work.

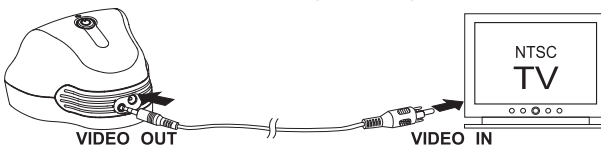

4. Using the Digital Reader

a) Turn ON

Press and hold power button for 1 second



This light will only illuminate when the battery power is low

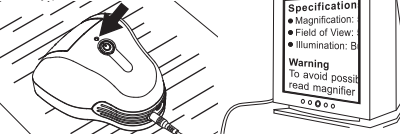

b) Turn OFF

Press and hold power button for 2 seconds

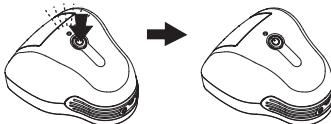

c) Low battery

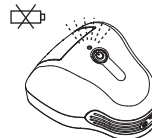

Specifications:

- Magnification: 8X ON 21" TV
- Field of View: 56X42mm
- Illumination: Built-in LED
- Resolution: 250K PIXELS
- Interface: TV NTSC
- Power: 3X AAA Batteries(Not included)
110V Power Adapter

Warning

To avoid possible permanent eye damage, do not place lighted Digital Reader directly upon human eye.

200mm